

# Particulate Filter F43

= "Most Popular"

## Specifications

|                         |                                     |                                     |
|-------------------------|-------------------------------------|-------------------------------------|
| Flow Capacity*          | 3                                   | 2900 SCFM (1368 dm <sup>3</sup> /s) |
| Maximum Supply Pressure | without DPI and with Pressure Gauge | 250 PSIG (17.2 bar)†                |
|                         | with DPI                            | 150 PSIG (10.3 bar)                 |
| Operating Temperature   | 32° to 150°F (0° to 65.5°C)         |                                     |
| Port Size               | NPT / BSPP-G 3                      |                                     |
| Bowl Capacity           | 14 oz                               |                                     |
| Standard Filtration     | 5 Micron                            |                                     |
| Weight                  | 32.8 lb. (14.9 kg)                  |                                     |

\* Inlet pressure 150 PSIG (10.3 bar). Pressure drop of 5 PSID (0.3 bar).  
 \*\* Without pressure indicator – Max. supply pressure is 250 PSIG (17.3bar).  
**"F" Series Filters, Type "A" 5 micron elements:** All Wilkerson Type "A" 5 micron elements meet or exceed ISO Class 3 for maximum particle size and concentration of solid contaminants.

## Materials of Construction

|                |              |
|----------------|--------------|
| Baffle         | Plated Steel |
| Body           | Aluminum     |
| Bowls          | Aluminum     |
| Deflector      | Plated Steel |
| Filter Element | Polyethylene |
| Seals          | Fluorocarbon |
| Stud           | Plated Steel |

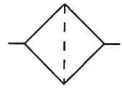

F43-0E-000

## Features

- Heavy-duty Cast Aluminum Housings to Withstand Operating Pressures Up to 250 PSIG\*
- Differential Pressure Indicator to Eliminate the Guesswork of Element Replacement
- Differential pressure gauge available, order separately, Kit DP3-01-000
- Unique Drain Mounting Plate Design Offers a Trouble-free Method for Interchanging and Installing External Drains
- 5 Micron High Flow Particulate Element

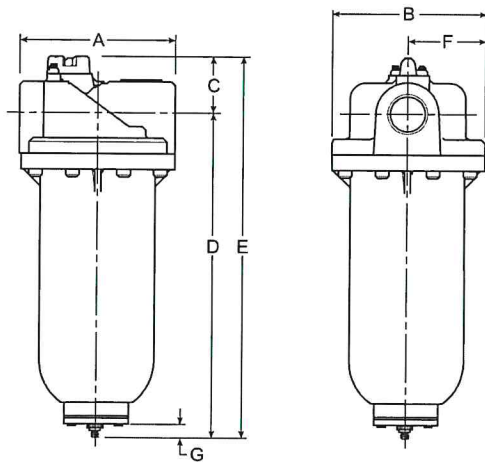

**NOTE:** Standard filter includes tapped 1/2 NPT / BSPP-G drain plate. To order internal float drain shown, order drain adapter plate GRP-95-391 and automatic drain GRP-95-981.

## Dimensions

| Models                      | Inches (mm) | A             | B               | C            | D                | E              | F               | G           |
|-----------------------------|-------------|---------------|-----------------|--------------|------------------|----------------|-----------------|-------------|
| Standard Unit<br>F43-0E-000 |             | 8.94<br>(227) | 8.88<br>(225.5) | 3.48<br>(88) | 25.96<br>(659.4) | 29.44<br>(748) | 4.44<br>(112.8) | .55<br>(14) |

B

Filters, Regulators, Lubricators

= "Most Popular"

**Replacement Element Kit**

Element, F43, 5 Micron, Fluorocarbon O-rings.....FRP-95-508

**Accessories**

Cap, Differential Pressure Indicator –  
For pressures over 150 PSIG..... GRP-95-022

Drain, Automatic, Internal, Fluorocarbon,  
1/8 NPT ..... GRP-95-981

Drain Plate Kit –  
1/2 NPT tapped drain port ..... GRP-95-393  
5/16 Dia. Drain Port,  
For use with Internal Auto Drain ..... GRP-95-391

Gauge, Differential Pressure ..... DP3-01-000

Indicator, Differential Pressure..... DP2-02-001

Manual Drain Kit  
Includes 1/2" Drain Plate, Manual Drain..... GRP-95-392

Manual Override for Auto Float Drain –  
GRP-05-981 Required ..... GRP-96-000

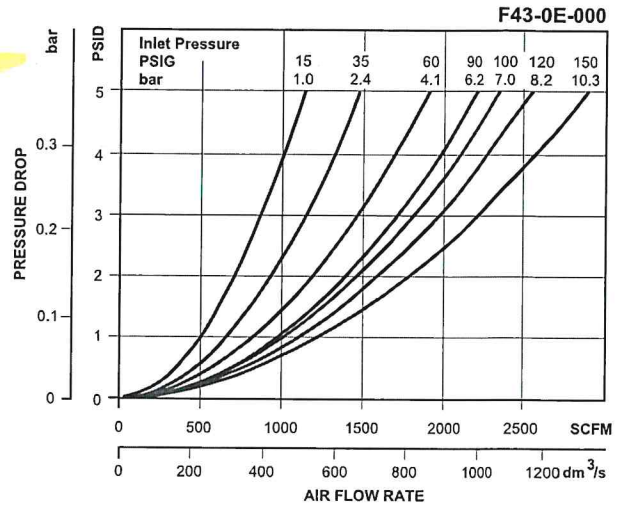

**B**  
Filters, Regulators, Lubricators

**Ordering Information**

| Model Type | Port Size | Metal Bowl  |
|------------|-----------|---|
| F43        | 3         | F43-0E-000<br>(Includes 1/2 NPT / BSPP-G Drain Plate) |

Options - To order an option supplied with the unit model, add the appropriate coded suffix letter in the designated position of the model number.

# Accessories – Filters

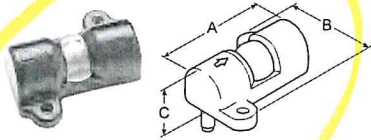

**Differential Pressure Indicator**  
DP2-01-000, DP2-01-001

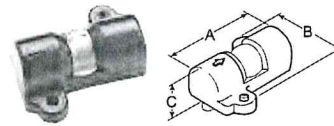

**Differential Pressure Indicator**  
DP8-01-000

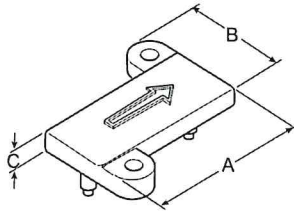

**Cap, Differential Pressure Indicator**  
GRP-95-020, GRP-95-022

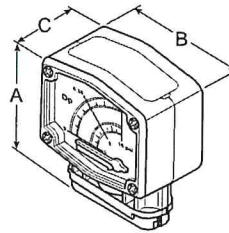

**Differential Pressure Gauge**  
DP3-01-000

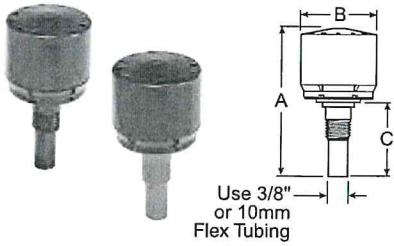

**Automatic Drain**  
GRP-95-973, GRP-95-981

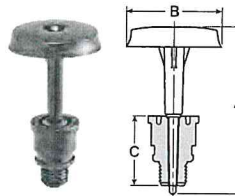

**Piston Drain**  
GRP-96-716



(Use with GRP-95-981 shown above. Order separately)

**Manual Override for Auto Float Drains**  
GRP-96-001

## Dimensions Inches (mm)

| Accessories   | Part Number | Used On                                     | A              | B              | C              |
|---|-------------|---|----------------|----------------|----------------|
| <b>Differential Pressure Indicator</b>  | DP2-01-000  | M16, M21, M26, M30, M31, M32                | 2.12<br>(54)   | 1.85<br>(47)   | 0.84<br>(21)   |
|   | DP2-01-001  | F35, F36, F37, F43, M35, M36, M37, M43, M45 |                |                |                |
|   | DP8-01-000  | F18, F28, M18, M28                          | 2.12<br>(54)   | 1.85<br>(47)   | .84<br>(21)    |
| <b>Cap, Differential Pressure Indicator (Pressures over 150 PSIG, 10.3 bar)</b> | GRP-95-020  | M16, M21, M26, M30, M31, M32                | 2.12<br>(54)   | 1.85<br>(47)   | 0.25<br>(6.3)  |
|   | GRP-95-022  | F35, F36, F37, F43, M35, M36, M37, M43, M45 |                |                |                |
| <b>Differential Pressure Gauge</b>  | DP3-01-000  | M32, M42                                    | 3.0<br>(75.9)  | 2.55<br>(65)   | 1.54<br>(39)   |
| <b>Automatic Drains, Nitrile</b>  | GRP-95-973  | F18, M18, B18 F28, M28, B28                 | 2.93<br>(74.4) | 1.47<br>(37.3) | 1.17<br>(29.7) |
| <b>Automatic Drains, Fluorocarbon</b>   | GRP-95-981  | F16, F26, F30, F35, F36, F43                |                |                |                |
| <b>Manual Override for Auto Float Drains</b>                                    | GRP-96-001  | GRP-95-981                                  | —              | —              | —              |
| <b>Piston Drain</b>   | GRP-96-716  | F08, M08, B08                               | 1.70<br>(43)   | .94<br>(24)    | .68<br>(17)    |

D  
Accessories & Repair Kits