



### Specification

Model	MVHS				
Bore No.	8A	10A	15A	20A	
Port size	R1/4	R3/8	R1/2	R3/4	
Medium	Air				
Operating pressure range	0.05~1 MPa				
Effective orifice (mm <sup>2</sup> )	P→A	30.4	32.3	63.5	85.4
	A→R	34.1	36.8	71.7	90.7
Ambient temperature	-5~+60°C (No freezing)				
Weight	40 g	54 g	132 g	148 g	

### Order example

**MVHS — 8A — G**

MODEL

8A: R1/4  
10A: R3/8  
15A: R1/2  
20A: R3/4

PORT THREAD  
Blank: Rc thread  
G: G thread  
NPT: NPT thread

### MVHS-\*A

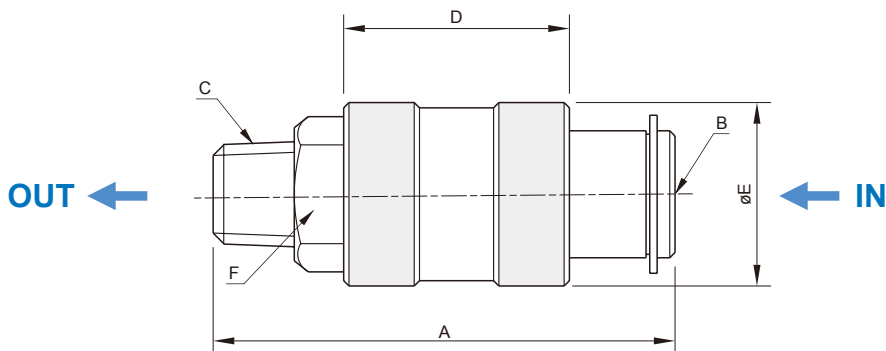
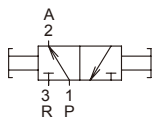

Code Model	A	B	C	D	E	F
<b>MVHS-8A</b>	58	Rc1/4	R1/4	32	25.5	⊘19
<b>MVHS-10A</b>	57	Rc3/8	R3/8	32	31.5	⊘22
<b>MVHS-15A</b>	91	Rc1/2	R1/2	49	38.5	⊘27
<b>MVHS-20A</b>	91	Rc3/4	R3/4	49	42	⊘35