

MESH2 series

MINIATURE ELECTRIC CYLINDER (WITH MOTOR)

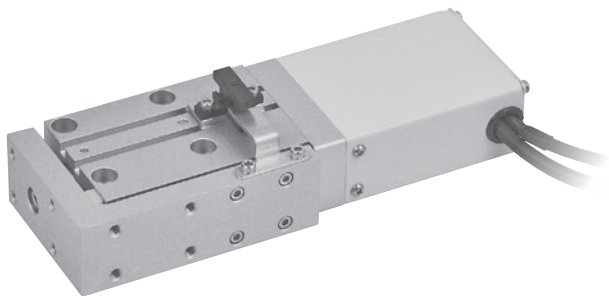

Specification

Model	MESH2		
Size	16	20	
Positioning repeatability (mm)	±0.02		
Lead (mm)	2	2	8
Maximum speed *1 (mm/s)	≤50	≤100	≤400
Work load *2	Horizontal (kg)	3	1.5
	Vertical (kg)	0.8	0.8
Pushing force *1,3,4 (N)	24 ~ 68	64 ~ 195	18 ~ 48
Stroke (mm)	30 / 50		
Motor size (mm)	□20	□28	
Rated voltage	DC 24V±10%		
Sensor switch	RLT (Please refer to page 5-16)		

*1. The speed and force may change depending on the cable length, load, stroke and mounting conditions.

*2. The maximum load capacity decreases as the speed increases.

*3. The accuracy of pushing force is ± 20%.

*4. Pushing force for MESH2 is from 30% to 90%.

Motor type	Step motor	Transmission	Ball screw
Environment	Standard	Guide type	Linear guideway

Order example

MESH2 - 16 L02 - 30 - CK10 03 N 015 - XA00

Model	Size	Ball screw lead	Stroke	Controller	I/O type	I/O cable length	Special order no.
	16	L02 2 mm	30 30 mm	CK10	N NPN	015 1.5 m	
	20	L02 2 mm L08 8 mm	50 50 mm	CM20 *1		03 3 m	
							* Standard: 1.5 m

Power + Encoder cable of motor	
01	1 m *2
015	1.5 m *3
03	3 m
05	5 m
	* Standard: 3 m

*1. Sensors would be needed.
*2. Only for CM20.
*3. Only for CK10.

Slot-type photomicro sensor set * With cable 2m.

RLT - N - MESH2 - 16 - 1

Model	I/O type	Size	Sensor quantity
	N NPN	16 20	1 1 pc 2 2 pcs

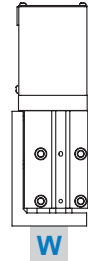
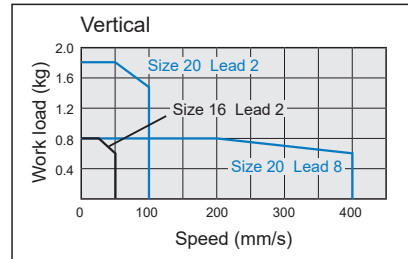
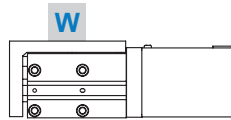
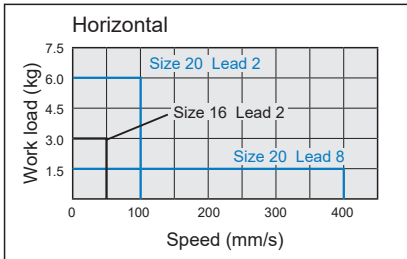

Speed-load curve diagram

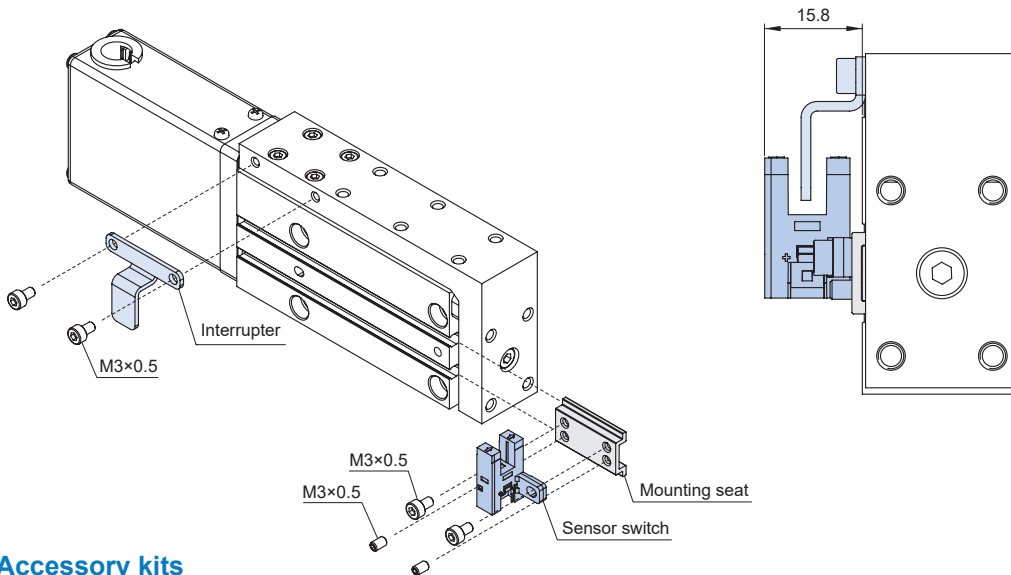

Slot-type photomicro sensor set

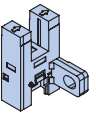
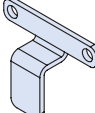
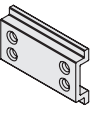

Accessory kits

		
Sensor switch (×1)	Interrupter (×1)	
		
Mounting seat (×1)	Bolt (×4)	Bolt (×2)

* With cable 2m.

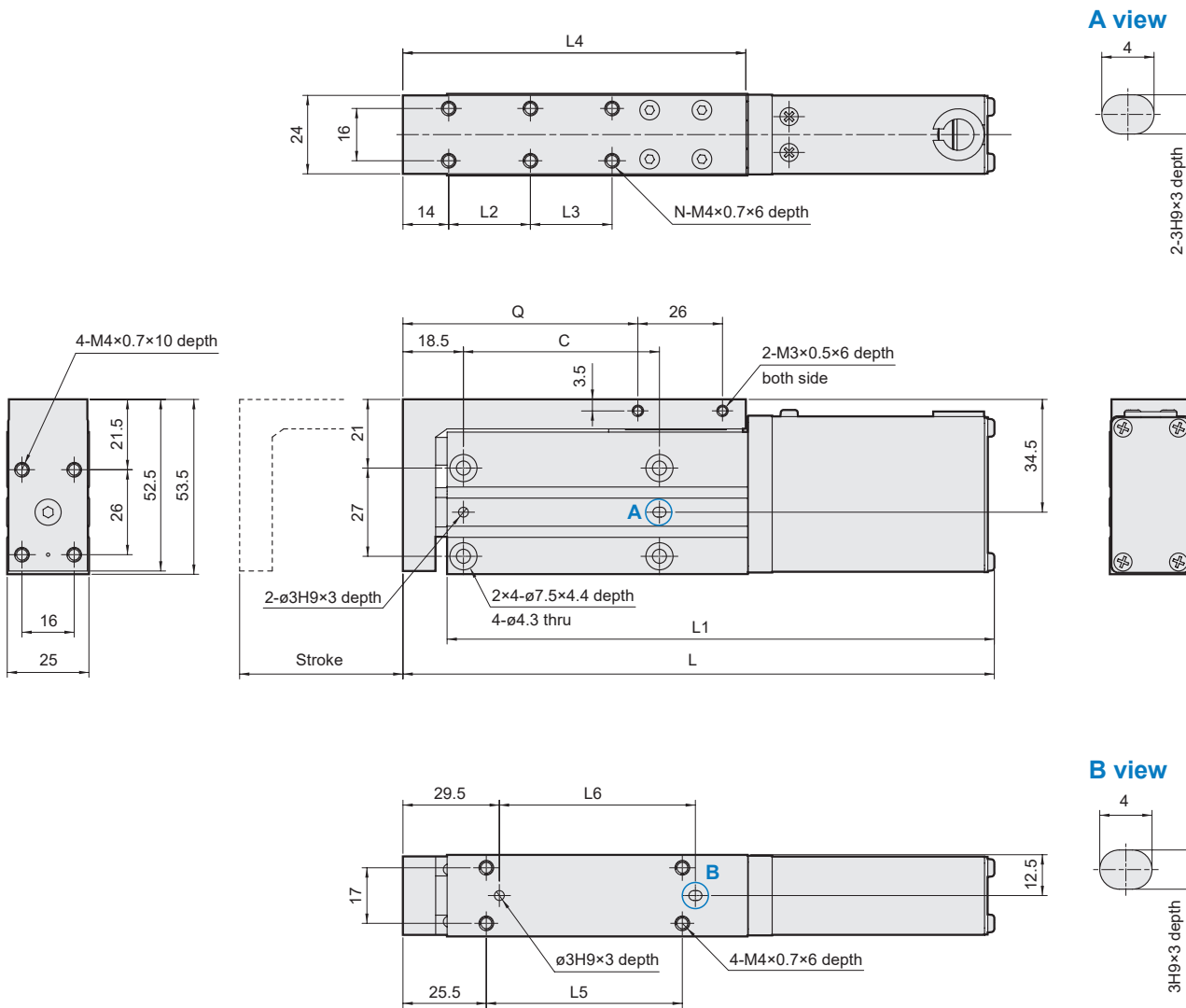

Unit: mm

Stroke	C	L	L1	L2	L3	L4	L5	L6	N	Q	Weight (g)
30	40	161	147.5	30	-	85	40	40	4	52	500
50	60	181	167.5	25	25	105	60	60	6	72	562

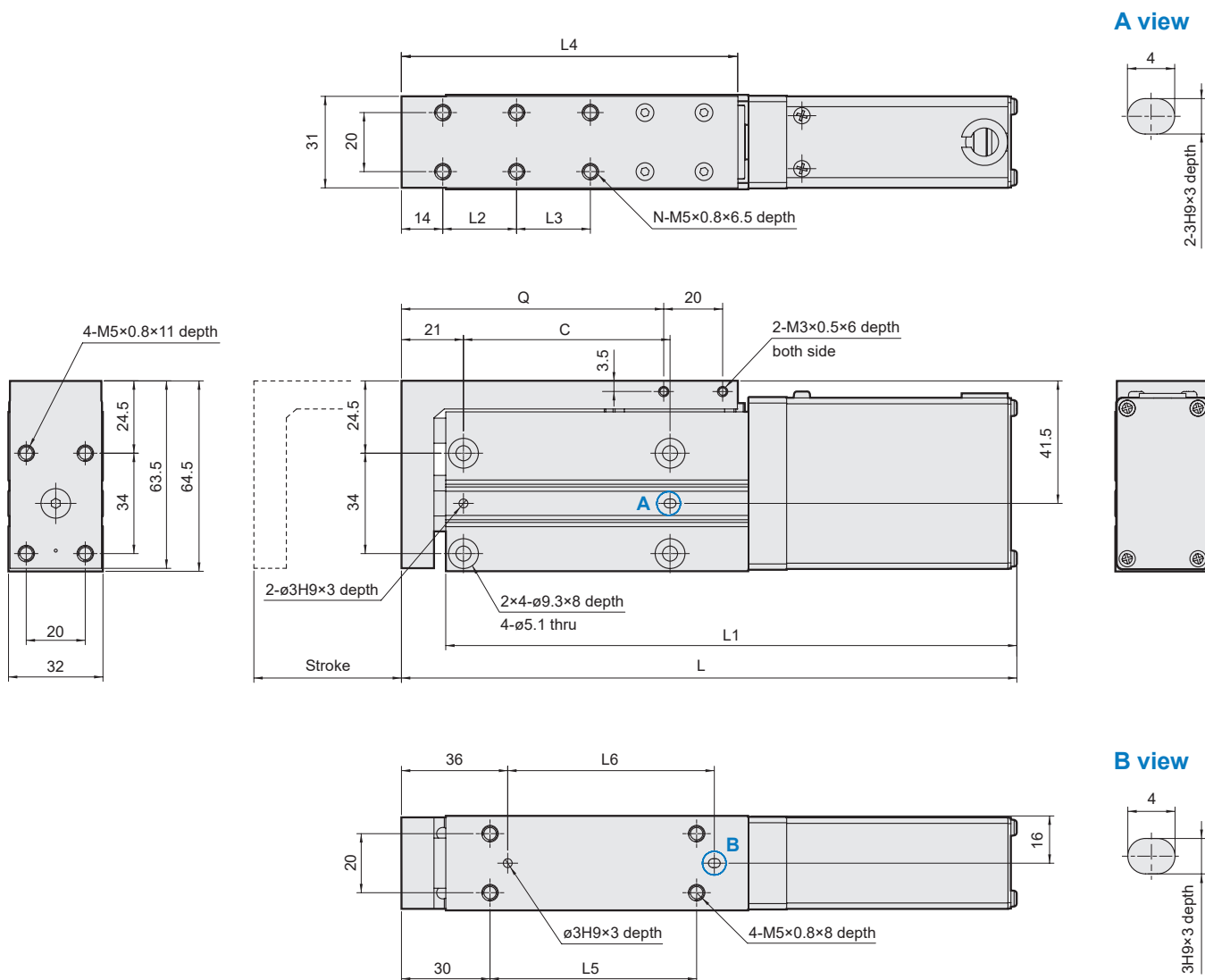

Unit: mm

Stroke	C	L	L1	L2	L3	L4	L5	L6	N	Q	Weight (g)
30	40	188.5	173.5	30	-	97	40	40	4	69	950
50	70	208.5	193.5	25	25	114	70	70	6	89	1049